

TILT SENSOR SWITCH

Item No.	SRBS100610T	Description	Ball-Contact	Version	18
Page	1 of 6		Publish Date	May. 7, 2018	

● FUNCTION

25° Tilt Detecting for 4 Directions in horizontal position.

● APPLICATIONS

1. Wake up systems for power saving, such like remote controllers
2. Automatically shut off for home appliances
3. Automatically shut off for Sporting equipment
4. Alarm system
5. Anti-theft / Anti-tamper devices
6. Being motion detection (personal locator)

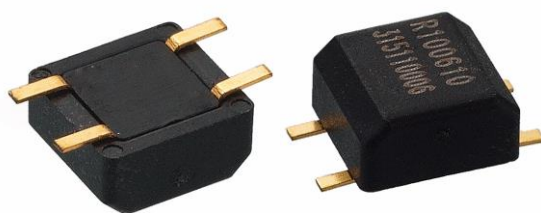

● FEATURES

1. Suitable to use for horizontal PCB.
2. Switch State: SMD Normal open.
3. Small size & compact space.
4. Housing made of high insulation plastic material, free from electric conduction and rust problem.
5. Terminals and balls are gold plated to enhance the life.
6. All plastic material subject to industrial purpose meets high temperature and fireproof function.
7. Simple switch signal, easy for circuit design.
8. Comply with RoHS, complete replacement of mercury switch and meet environmental protection.
9. More economic than IC design.
10. All made in Taiwan and examined before shipment.



TILT SENSOR SWITCH

Item No.	SRBS100610T	Description	Ball-Contact	Version	18
Page	3 of 6		Publish Date	May. 7, 2018	

● DIMENSIONS / OPERATION / P.C.B. LAYOUT (Unit: mm, Tolerance: $\pm 0.25\text{mm}$)

Fig. 1

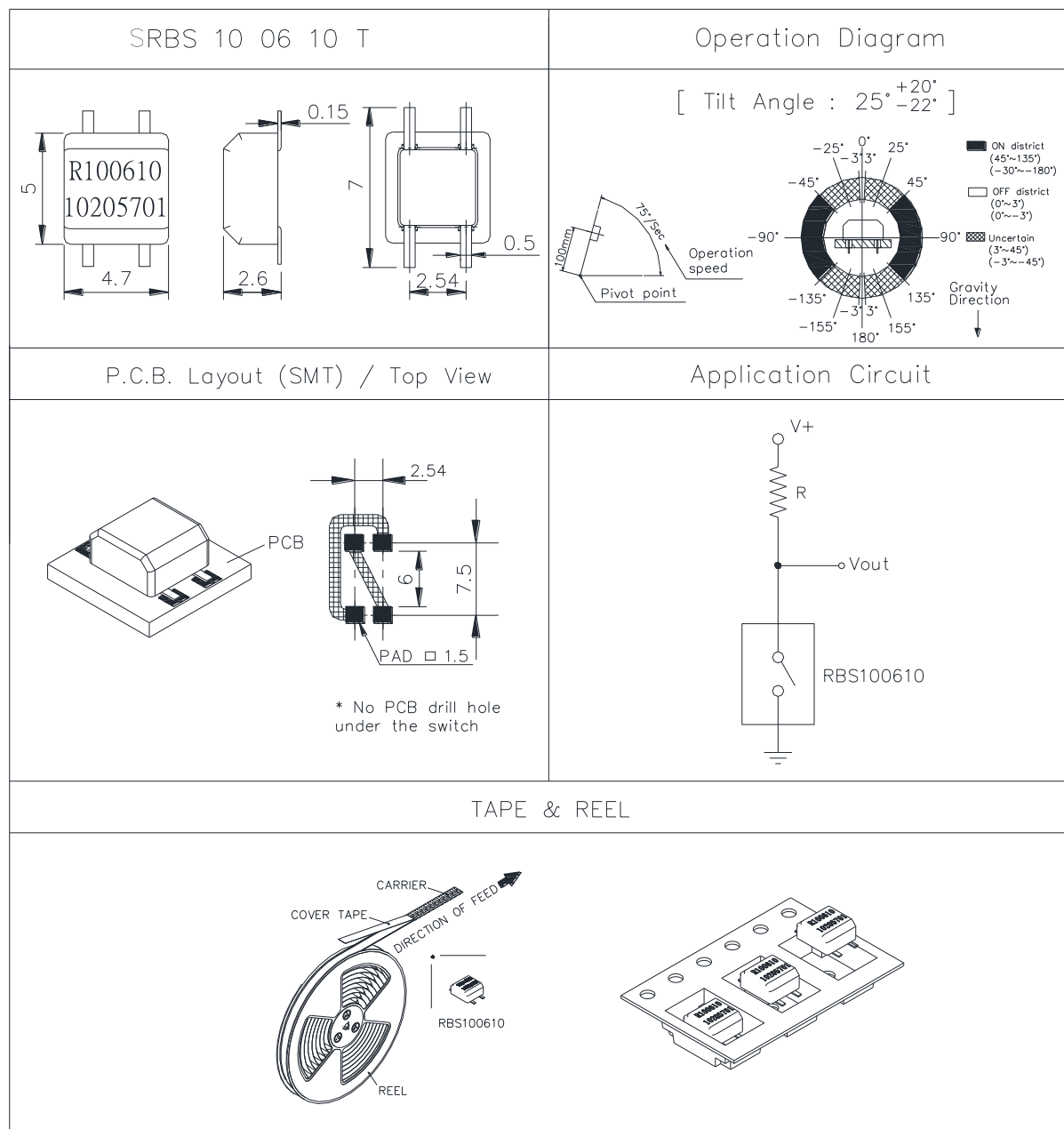

TILT SENSOR SWITCH

Item No.	SRBS100610T	Description	Ball-Contact	Version	18
Page	4 of 6		Publish Date	May. 7, 2018	

● Current/Voltage Suggested

Input Current (mA)	Operating Voltage (V)	Condition
1.0	5~12	--

● ELECTRICAL CHARACTERISTICS

1.	Contact Rating	10 mA, 5VDC
2.	Contact Resistance	50 Ω max.
3.	Operation Diagram	Refer to Fig. 1
4.	Insulation Resistance	50 MΩ min. At 100 VDC
5.	Dielectric Strength	50 VDC min. For 1 minute
6.	Capacitance	5pF max
7.	Conductive Rate	85% min.

● RELIABLE TEST ITEMS

Reliable Test for SRBS100610T

	Test Item	Contents
1	Operating Temperature	-25°C ~ 85°C
2	Storage Temperature	-40°C ~ 85°C
3	Humidity	40 °C / 95 %RH
4	Mechanical Life	2 Hz horizontal 1,000,000 times
5	Electrical Life	100,000 times



TILT SENSOR SWITCH

Item No.	SRBS100610T	Description	Ball-Contact	Version	18
Page	5 of 6		Publish Date	May. 7, 2018	

● SOLDERING CONDITION

Following soldering conditions are for reference only, please use soldering information that solder paste manufacturer recommends.

Condition Suitable Production Process	Soldering Temperature	Soldering Time	Wattage of Manual Soldering	Type
Manual Soldering	300±5°C	< 3 seconds max.	30W or Temperature- controlled manual soldering	SMD

● PACKAGE

	Parts No.	Package	Quantity	Total Quantity	Dimension(mm)
1.	SRBS100610T	Tape & Reel	2,500 pcs	2,500 pcs	φ330*12.5H
		Inner box	2 Reels	5,000 pcs	355L*340W*68H
		Carton	4 Boxes	20,000 pcs	373L*358W*309H

※ Package shown as below for reference.



Tape & Reel



Inner Box

Carton



TILT SENSOR SWITCH

Item No.	SRBS100610T	Description	Ball-Contact	Version	18
Page	6 of 6		Publish Date	May. 7, 2018	

● NOTES

1. Suggestion for usage: For vibration usage or application, we suggest to add hysteresis for IC; if vibration is heavy, optical type of sensor switch is recommended.
2. For the continued product improvement as one of the company policy, specifications may change or update without notice. The latest information can be obtained through our sales offices. Normally, all products are supplied under our standard conditions.
3. If buyer's products will stay in power supply for a long time which needs very high stability, optical sensor switch is strongly recommended.

● PRECAUTIONS FOR USE

1. If the products are intended to be used for other endurance equipment requiring higher safety and reliability such as life support system, space and aviation devices, disaster and safety system, it's necessary to make verification of conformity or contact us for the details before using.
2. Don't try to clean the switch with a solvent or similar substance after the soldering process.
3. Use water-soluble flux may damage the switch.
4. Please follow the soldering instruction accordingly, otherwise might lead to defective.
5. Do not use switch in the environment of high humidity, because such an environment may cause the leakage current between the terminals.
6. Please do not exceed the rated load as there will be a risk of disabling the product function.
7. In the circuit, switch should not be near or directly connected with the magnetic component solder joints (for example: relays, transformers, etc.).

